

CYLINDA

Service Information**Ceramic hob****IH 710**

8579 619 61000

Last Modification: 01/13/12

Creation Date: 10/20/11

Spare Part List	2
Exploded View	3
Technical Data	4
Dimensional Sketch	5
Wiring Diagram	6
Error Codes	8
Configuration Description	9
Configuration code	10

This document is only intended for qualified technicians who are aware of the respective safety regulations.
Subject to modifications

Spare Part List

Pos	12NC	Description
0310	4810 104 53937	Hob assembly
0340	4810 104 20949	Clamping spring
4620	4801 211 04129	Heating element 145mm 1200W
4621	4801 211 04128	Heating element 180mm 1700W
4623	4801 211 01745	Heating element 210mm 2300W
4910	4812 290 68293	Connection block 5-way
4914	4812 468 18385	Cover touch control
5211	4812 214 58619	Unit control Touch Control 4
9020	4812 404 49908	Bracket 145
9021	4812 404 49838	Bracket 180
9022	4812 404 49661	Bracket 210
9026	4812 404 49658	Bracket 145 rear
9640	4812 466 88967	Gasket mm.2765

Exploded View

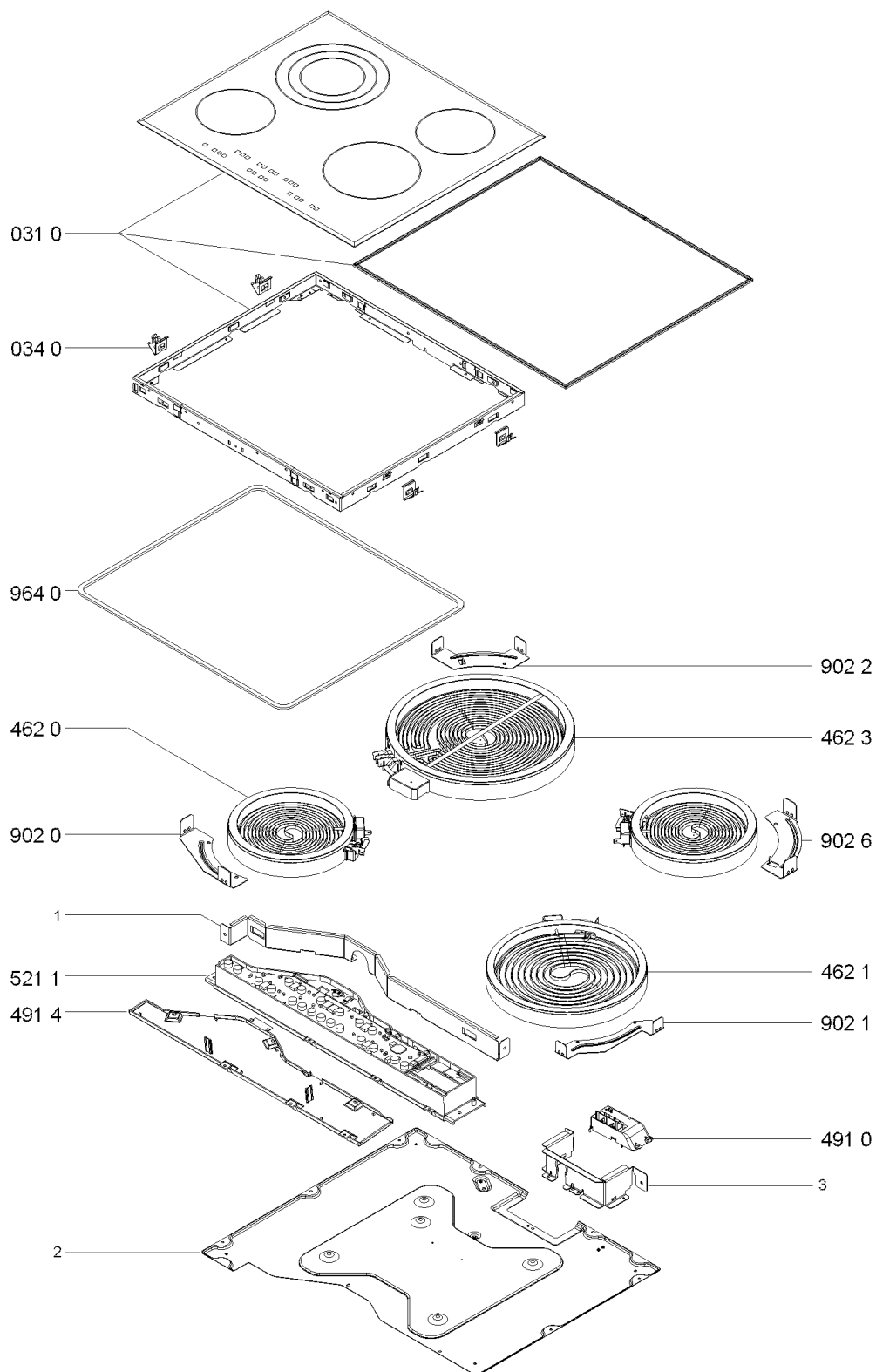

4000 104 62572

Technical Data

Electrical base data

Rated voltage 230 V~
Main connection 400 V 3N~400 V 2N~230 V 1N~50 Hz

Power Consumption

Total connected load 6400 W

Electrical components

Hob control
Electronic touch control

Cooking zones

Front left
Diameter 145 mm
Power 1200 W
Front right
Diameter 180 mm
Power 1700 W
Rear left
Diameter 210 mm
Power 2300 W
Rear right
Diameter 145 mm
Power 1200 W

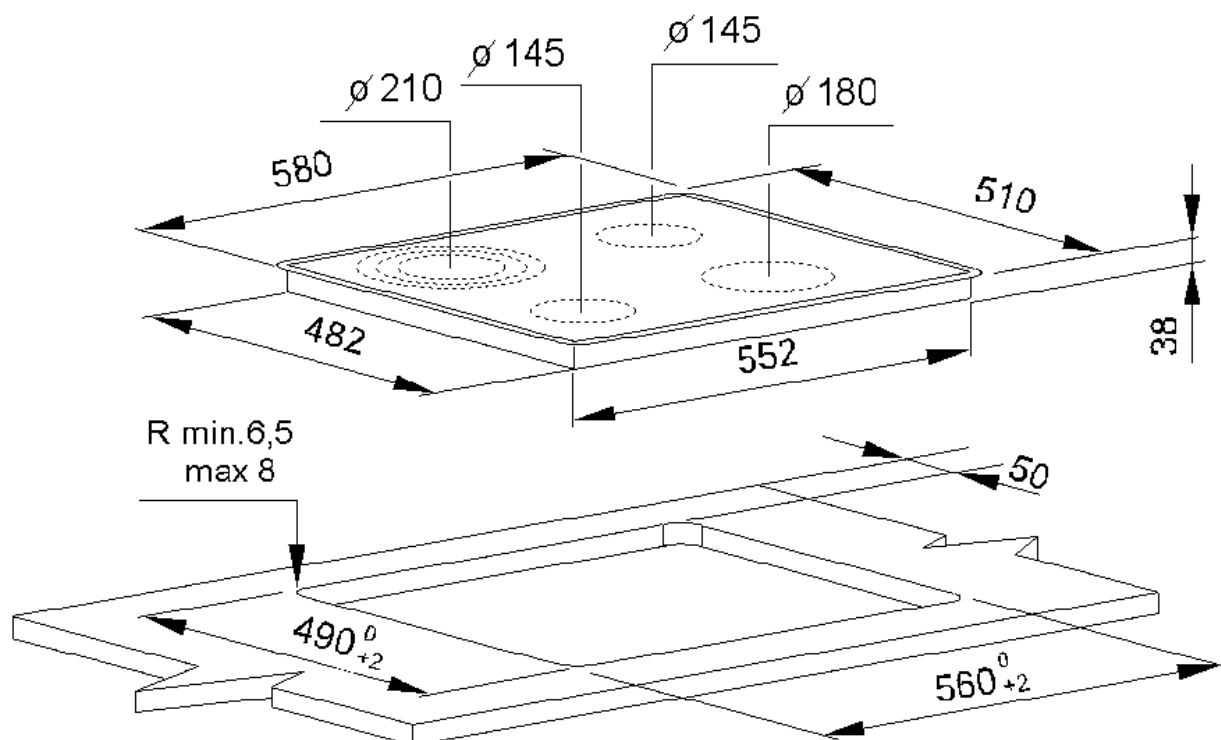
Dimensional Sketch**Z8100159**

Wiring Diagram

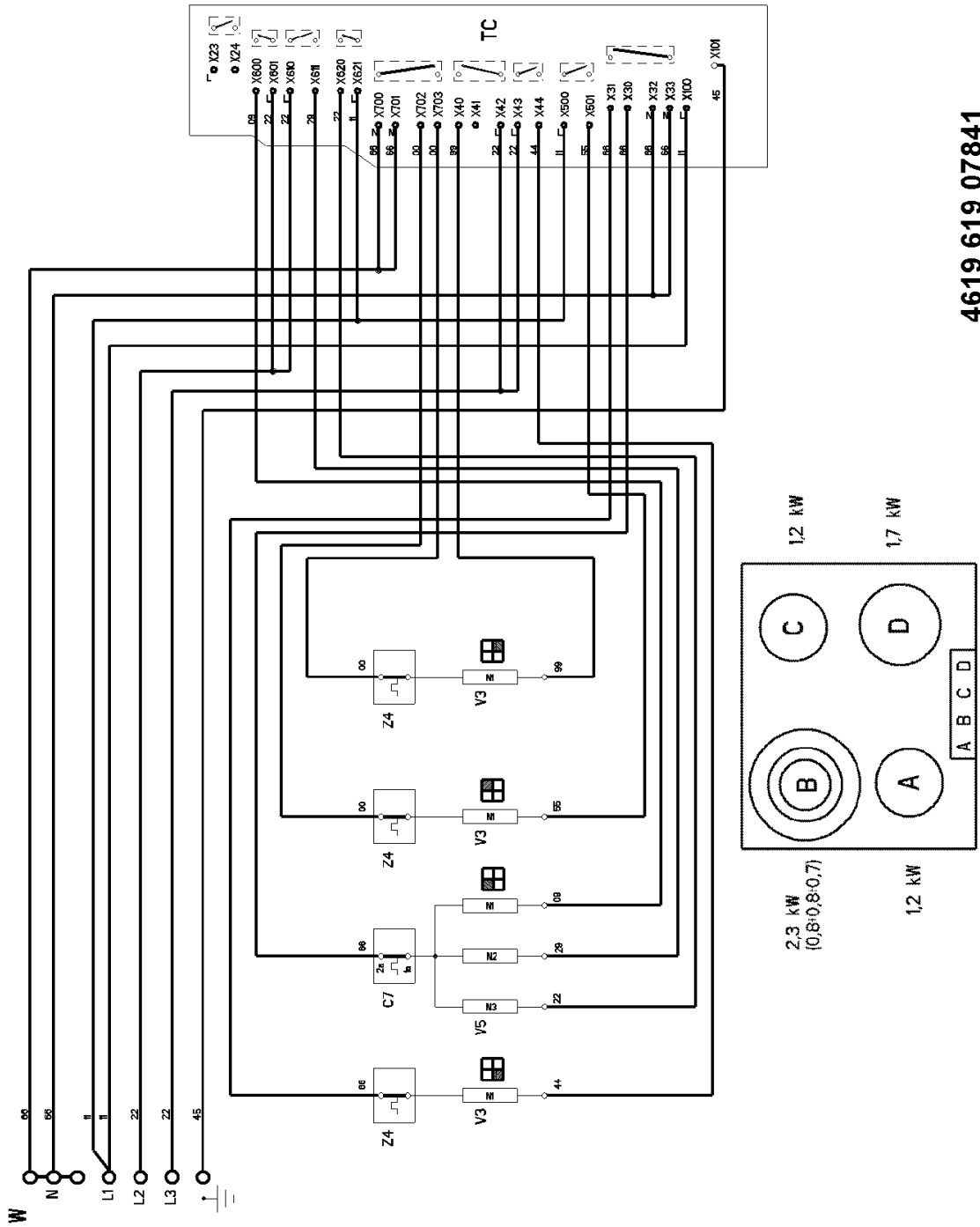

4619 619 07841

TIPO - 6E

Legend

TC ELECTRONIC TOUCH CONTROL
V3 ELECTRICAL HOT PLATE
V5 ELECTRICAL HOT PLATE (3 ZONES)
W MAINS TERMINAL BOARD
Z4 BI - METAL
C7 HOT PLATE THERMOSTAT

00 BLACK
11 BROWN
22 RED
33 ORANGE
44 YELLOW
55 GREEN
66 BLUE
77 VIOLET
88 BLUE SKY
99 WHITE
09 WHITE - BLACK
29 WHITE - RED
49 WHITE - YELLOW
69 WHITE - BLUE
90 GREY
45 YELLOW - GREEN

61907841en

Error Codes

Code	Failure	Action/Repair
Er 03	Key or Keys pressed longer than 30 seconds.	Ensure surface is clean and free of utensils.
Er 21	TC Overheated, electronics shut down to prevent damage.	Allow product to cool and check ventilation.
Er 22	Incorrect signal from keyboard.	Change TC module.
Er 400	Power overload.	Check mains supply the limit is 300V.
Er 36	TC NTC out of range (either S/C or O/C).	Change TC module.
Er 40	TC internal voltage too low.	Disconnect from power, if fault doesn't clear replace TC Module.

81002696

Configuration Description

Configuration procedure

ENTERING THE SERVICE MENU

Within the first 2 minutes after power connection and before the touch is switched on.

If no keys are pressed for 2 minutes the product will exit the menu and switch off.

Access

Press and keep pressed the **"key lock"** key, then press three times the front right zone "⊕" key keeping it pressed the third time. Keep both keys pressed for 3 seconds, the machine will beep to indicate the configuration is active. Release both keys at this point.

Display

The front left 7-seg shows a flashing "C" alternating with the configuration step (from 1 to 9).

The right 7-seg. (rear and front) displays shows the configuration value for the step. The rear is the tens and the front is the units.

Note: rear left and timer displays have been not used as they are not used on all UI types.

Changing the Configuration value

To increase the value press the front right zone "⊕" key, to decrease press the "front right zone "-" key,

Changing the Configuration step

To go to the next step press the front left zone "⊕" key,

leaving the menu

-to store the current values of all menu entries you have to press **the keylock key** key for about 2 seconds. The successfully end of the store has to be highlighted by a beep and all the displays will be switched on for a while.

-to leave without storing you have to press the ON/OFF key. In this case the "wrong operation sound" will be given and the displays will start as after a reset.

Type →	L2	L2 A	L2B	L5B	L6A	L6B	L6C	L6D	L6E	L7	L8	L9	note
Step ↓	Configuration Value												
1	3	2	1	5	7	8	9	10	11	12	13	14	Features
2	1	2	3	6	7	8	9	10	11	12	13	14	Realy/Zone
3	N/A												
4	15	15	15	15	15	15	15	15	15	13	13	13	Features options
5	8												Features options
6	9												Features options
7	0 (Fixed)												Test Result
8	0												Demo Mode
9	2												Keyboard type

81002843en

Configuration code

..... L6E